

*A company dedicated to solving ergonomic and material handling problems since 1955.*

**Ergonomic Solutions**

# OWNER'S MANUAL

**PANEL CART • model PRCT**  
**HEAVY DUTY PANEL CART • model PRCT-HD**

<b>Contents</b>	
Safety Precautions .....	1
Receiving Instructions .....	1
Warranty .....	1
Assembly Instructions .....	2
Assembly & Parts Drawing .....	3 & 4
Warning Label Identification .....	3 & 4

## SAFETY PRECAUTIONS

**Read owner's manual completely before operating unit!**

- Never exceed the maximum capacity of 2,000 pounds.
- Load must be evenly distributed on platform to insure stability.
- Always apply wheel brakes when unit is not being moved.
- Always operate unit on a level surface to insure stability.
- Use caution in moving a loaded unit; avoid obstructions and floor defects.
- Make sure all operator safety labels are in place (p.2).

## RECEIVING INSTRUCTIONS

Every unit is thoroughly tested and inspected prior to shipment. However, it is possible that the unit may incur damage during transit. If damage is noticed when unloading, make a note of it on the BILL OF LADING. Remove all packing and strapping material, then inspect the unit again for damage. **IF DAMAGE IS EVIDENT, FILE A CLAIM WITH THE CARRIER IMMEDIATELY!**

## WARRANTY

This product is warranted for 90 DAYS from date of purchase to be free of manufacturing defects in material and workmanship. The manufacturer's obligation hereunder is limited to repairing such products during the warranty period, provided the product is sent prepaid back to the factory.

This warranty does not cover normal wear of parts or damage resulting from any of the following: negligent use or misuse of the product, use or application contrary to installation instructions, or disassembly, repair or alteration by any person prior to authorization from a factory representative.

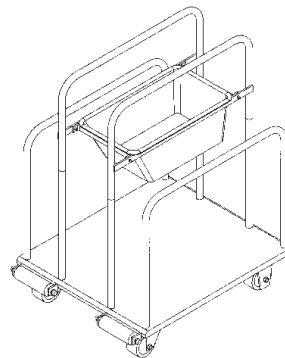

**PANEL CART  
 MODEL PRCT**

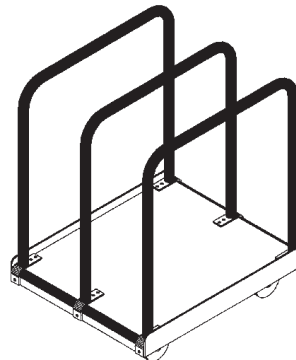

**HEAVY DUTY  
 PANEL CART  
 MODEL PRCT**

E  
N  
G  
L  
I  
S  
H

E  
S  
P  
A  
N  
O  
L

F  
R  
A  
N  
Ç  
A  
I  
S

---

## **PANEL CART • MODEL PRCT Assembly Instructions**

1.) Remove top basket retainer from base of panel cart. Slide down on the four upright posts in the center section of the cart base. (Loosen nuts and bolts on basket assembly if necessary for adjustment to fit.)

2.) For the caster assembly instruction:

Two rigid casters are to be installed on one end of the panel cart's base, and the two swivel casters on the opposite end.

Tip the panel cart onto its side. A caster pad bracket is located at each corner on the bottom of the frame. To mount a caster, place the caster's mounting plate onto the appropriate caster pad bracket.

Insert a 3/8" diameter x 5" long clevis pin through the square holes in the caster pad bracket. Insert a cotter pin through the hole in the end of the clevis pin and bend the end of one leg of the cotter pin to secure it.

Return the panel cart to its upright position.

3.) Return to upright position and lock swivel casters.

4.) Place black roller between brackets and insert 1/2" dia. roller pin provided through brackets and roller, leaving an equal length on each end. Tap on locking end caps to both ends of rod. Unlock wheel.

Refer to tpage 3 for the assembly drawing.

## **HEAVY DUTY PANEL CART • MODEL PRCT-HD Assembly Instructions**

### **INSTALL CASTERS**

Two rigid casters are to be installed on one end of base frame and two swivel casters at the other end. The swivel casters should be installed on the same end of the base as the roller brackets.

Tip the panel cart onto its side. A caster pad bracket is located at each corner on the bottom of the frame. To mount a caster, place the caster's mounting plate onto the appropriate caster pad bracket.

Insert a 3/8" diameter x 5" long clevis pin through the square holes in the caster pad bracket. Insert a cotter pin through the hole in the end of the clevis pin and bend the end of one leg of the cotter pin to secure it.

Return the panel cart to its upright position.

### **INSTALL HANDLES:**

Three handles are installed on top of base frame.

Return base frame to upright position and lock swivel wheels.

Attach handles to top of platform in pre-drilled holes.

Use 3/8" - 16 UNC x 1-1/4" bolts, flat washers, and 3/8" - 16 UNC lock nuts provided and tightened securely.

Unlock wheels.

Refer to page 4 for assembly drawing.

## PANEL RACK CART • MODEL PRCT Assembly & Parts Drawing

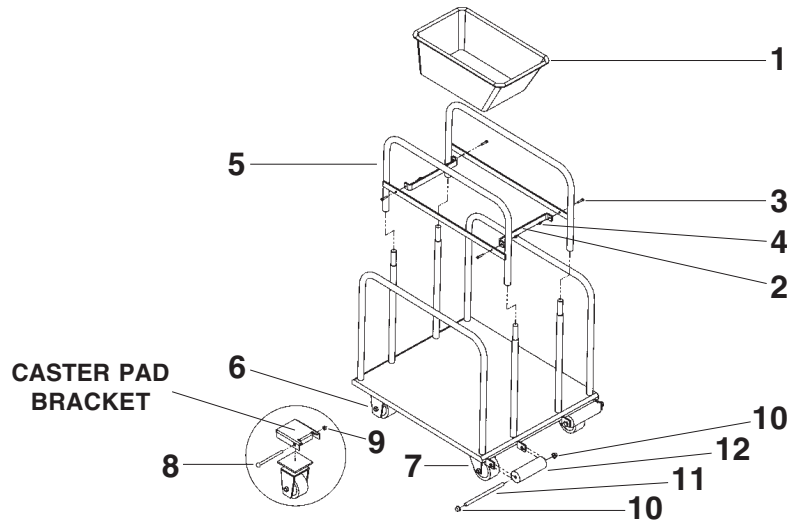

### PARTS IDENTIFICATION PANEL RACK CART • MODEL PRCT

KIT NO.	ITEM NO.	DESCRIPTION	ENGINEER NO.	PART NO.	QTY.
B	1	Basket	16-048-001	PC-BSK	1
B	2	Basket bar	16-016-052	PC-BBSKTBR	2
A,B	3	Bolt, 5/16"-18 UNC x 1"	a/k	a/k	4
A,B	4	Nylock nut, 5/16"-18 UNC	a/k	a/k	4
	5	Middle frame	16-514-006	PC-MIDFM	2
C	6	Wheel, (rigid caster)	16-132-016	PC-CASR	2
C	7	Wheel, (swivel caster w/ brake)	16-132-015	PC-CASBK	2
A,C	8	Clevis, 3/8" x 5"	99-112-006	n/a	4
A,C	9	Cotter Pin, 3/8"	a/k	a/k	4
D	10	End cap	16-130-001	PC-ECAP	4
D	11	Roller pin	16-112-002	PC-RPIN	2
D	12	Roller	16-027-001	PC-RLLR	2
	A	Bolt Kit (includes 3, 4, 8, 9)	16-154-004	PC-KIT-A	1
	B	Basket Kit (includes 1,2,3,4)	16-154-005	PC-KIT-B	1
	C	Wheel Kit (includes 6,7,8,9)	16-154-006	PC-KIT-C	1
	D	End Roller Kit (includes 10,11,12)	16-154-007	PC-KIT-D	1

a/k Available only with purchase of kit

### WARNING LABEL IDENTIFICATION MAKE SURE ALL WARNING LABELS ARE IN PLACE!

\* Product safety signs or labels should be periodically inspected and cleaned by the product users as necessary to maintain good legibility for safe viewing distance. ANSI 535.4 (10.21) Contact manufacturer for replacement labels.

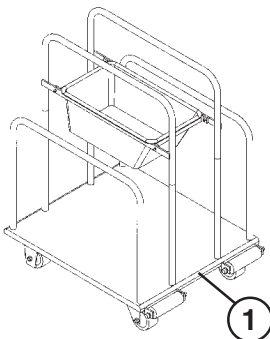

# HEAVY DUTY PANEL CART • MODEL PRCT-HD

## Assembly & Parts Drawing

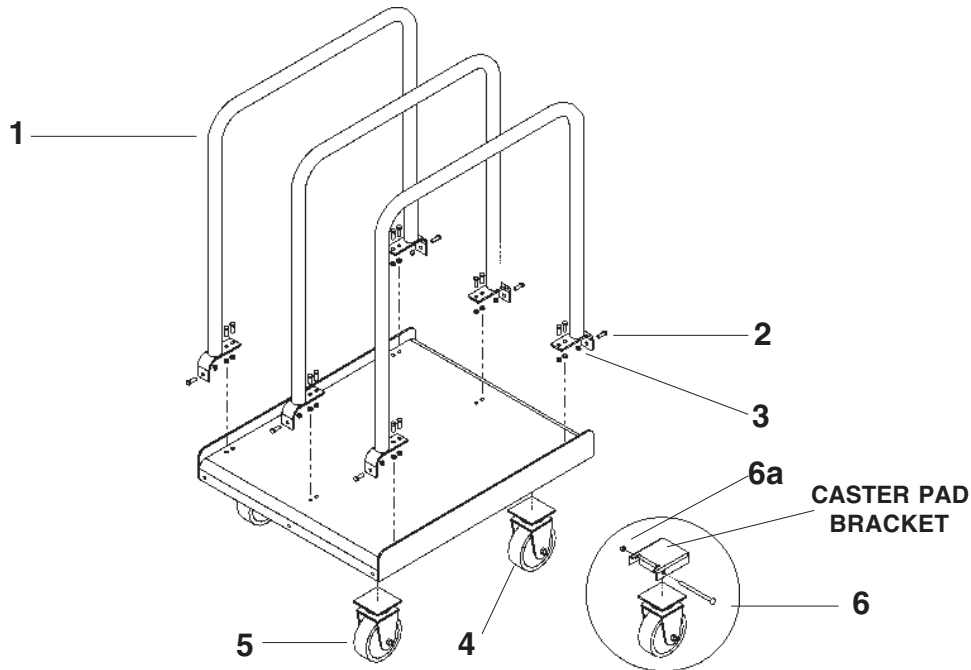

### PARTS IDENTIFICATION

#### HEAVY DUTY PANEL CART • MODEL PRCT-HD

KIT NO.	ITEM NO.	DESCRIPTION	ENGINEER NO.	PART NO.	QTY.
B	1	Handle	16-514-083	PCHD-HDL	3
A,B	2	Bolt, 3/8"-16 UNC x 1" (HHCS)	a/k	a/k	18
A,B	3	Nylock nut, 3/8"-16 UNC	a/k	a/k	18
C	4	Wheel, (rigid caster)	16-132-029	PCHD-CASR	2
C	5	Wheel, (swivel caster w/ brake)	16-132-127	PCHD-CASB	2
A,C	6	Clevis pin, 3/8"x 5"	99-112-006	n/a	4
A,C	6a	Cotter pin, 3/8"	n/a	n/a	4
	A	Bolt Kit (includes 2,3,6,7)	16-154-003	PCHD-KITA	1
	B	Handle Kit (includes 1-3)	16-154-008	PCHD-KITB	1
	C	Wheel Kit (includes 4-7)	16-154-009	PCHD-KITC	1

\*Item 6 and 6a are sold together  
a/k Available only with purchase of kit

### WARNING LABEL IDENTIFICATION

**MAKE SURE ALL WARNING LABELS ARE IN PLACE!**

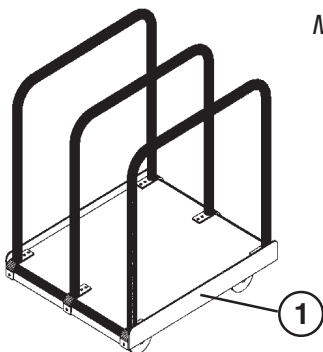

\* Product safety signs or labels should be periodically inspected and cleaned by the product users as necessary to maintain good legibility for safe viewing distance. ANSI 535.4 (10.21) Contact manufacturer for replacement labels.

